

Помпа потопяема дренажна с агитатор, за шламове, бетонни разтвори и тинести суспензии Tsurumi HSD2.55S

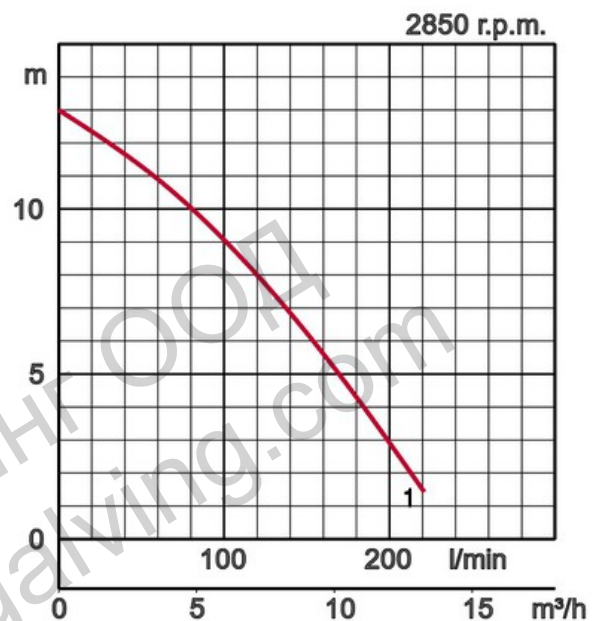

ø Discharge bore mm		50	
Pumping Fluid	Temperature	0-40°C	
	Type of Fluid	Sand carrying water, Sludge, Bentonite	
Pump	Components	Impeller	Semi-Vortex impeller
		Shaft Seal	Double mechanical seal
		Bearings	Shielded ball bearings
	Material	Impeller	Chromium iron casting
		Casing	Ductile iron casting EN-GJS-700-2
		Shaft Seal	Silicon carbide in oil bath
Motor	Type, Poles	Induction motor, 2 poles, IP68	
	Lubrication	Turbine oil (ISO VG32)	
	Motor Protector (built-in)	Miniature protector	
	Insulation	Insulation class E	
	Phase / Voltage	Single phase 230V / 110V / 50Hz	
	Material	Casing	Aluminium die casting
		Shaft	Stainless steel EN-X6Cr13
Cable		Rubber, H07RN-F	
Discharge Connection		Threaded flange/Hose coupling	



Components:

001 Cable	050 Motor cover
020 Pump casing	051 Head cover
021 Impeller	052A Upper bearing
023 Strainer	052B Lower bearing
024 Agitator	053 Motor protector
025 Mechanical seal	054 Shaft
026 Oil sealing	055 Rotor
029 Oil casing	056 Stator
030 Oil lifter	064 Motor casing
032. Outlet	068 Handle
035 Oil plug	071 Shaft sleeve
036 Lubricant	076 Condensor

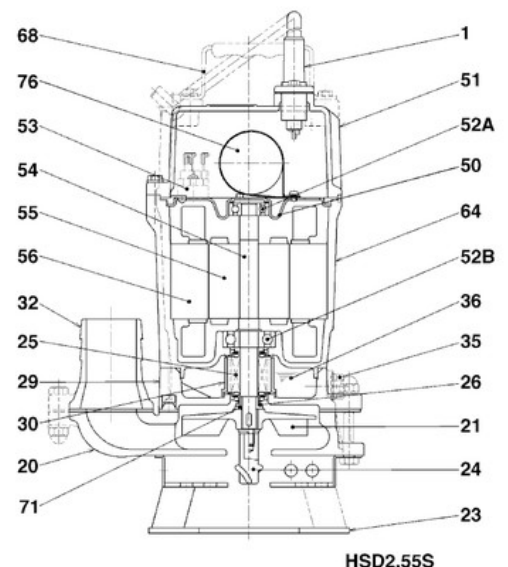

HSD2.55S

Dimensions in mm:

Model	d	A	A1	B	B1	D	H	W1
HSD2.55S	50	241	200	171	97	186	421	105

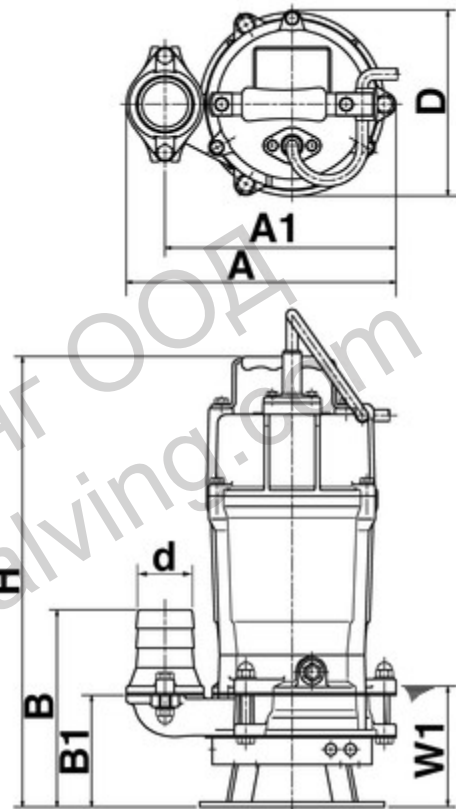

W1: lowest running water level

Specifications:

Model	Colour code curve	Bore mm	Motor output kW	Rated current A	Head max. m	Capacity max. l/min	Dry weight kg w/o cable	Max. solid handling ø mm	Pressure resistance max. m	Cable length m
HSD2.55S	 1	50	0,55	3,4	13,2	220	14,0	10	10	10